

Republic Manufacturing offers butterfly valves for controlling the pressure and flow of centrifugal blowers on air knife systems.

Republic's Butterfly Valves allow air to flow even when fully closed to **protect the blower** from reaching the point of dead-head. These valves help control the blower pressure and flow to obtain **optimal performance**.

Constructed of aluminum or stainless steel, these quarter-turn valves are fully adjustable and locking so the pressure and flow remain constant at the level that provides optimal performance. The valve is male NPT threaded in sizes ranging from 2" to 6" for ease of installation. They are durable and corrosion resistant; and the stainless steel valves are suitable for food production.



Features

- Anodized aluminum or stainless steel construction
- Fully adjustable locking lever
- 2", 3", 4", 5", 6" NPT valves available
- Disk designed so the blower will not dead-head
- Durable construction
- Corrosion resistant

Advantages

- Control the blower flow and pressure to obtain optimal performance
- Reduce energy consumption
- Avoid over-amping the motor
- Reduce back pressure
- Easy to install

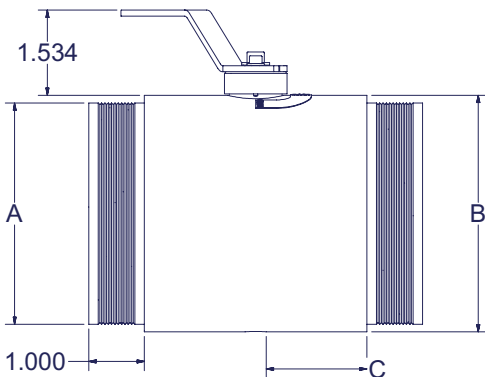

Inlet size	Part Number	A	B	C
		Aluminum		
2"	200-0502	1.98"	2.25"	2"
3"	200-0501	2.98"	3.25"	3"
4"	200-0500	3.98"	4.25"	4"
5"	200-0499	4.98"	5.25"	4"
6"	200-0498	5.98"	6.25"	4"
Stainless Steel				
2"	200-0502S	1.98"	2.25"	2'
3"	200-0501S	2.98"	3.25"	3"
4"	200-0500S	3.98"	4.25"	4"
5"	200-0499S	4.98"	5.25"	4"
6"	200-0498S	5.98"	6.25"	4"